

# HARDING TOWNSHIP

## Hunting

### POLICY AND PROCEDURES

<b>VOLUME: I</b>	<b>CHAPTER: 8</b>	<b>EFFECTIVE DATE: 08-24-2017</b>			
<b>SUBJECT: Hunting</b>					
<b>REFERENCE:</b>			<b>SPECIAL INSTRUCTIONS:</b> Copy of Policy to Harding Land Trust & Environmental Commission Chair		
<b>APPLICABILITY:</b> All Employees			<b>NUMBER OF PAGES:</b> 13		
<b>ADMINISTRATOR:</b> Robert Falzarano			<i>Robert J. Falzarano</i>		
<b>REVIEW DATE:</b>					
<b>REVISIONS</b>					
<b>DATE:</b>	<b>SECTION:</b>	<b>APPROVED BY:</b>	<b>DATE:</b>	<b>SECTION:</b>	<b>APPROVED BY:</b>
8-15-18	I A 7/12, I B 8, II E 4e, Appendix #2, #3 & #4	Robert Falzarano <i>RJF</i>	8-20-18		
7-10-19	Appendix #1, #3 & #4	Robert Falzarano <i>RJF</i>	7-10-19		
8-24-20	Page 4-D-#2 Appendix #3-#16	Robert Falzarano <i>RJF</i>	8-24-20		

**POLICY:** Applications for hunting in Harding Township must be handled with consistent uniformity and in accordance with the New Jersey State Law and Regulations. The policy and procedures set forth herein are intended to ensure and facilitate the procedures for Harding Township property and the properties under the control of The Harding Land Trust.

## PROCEDURES:

### I. Harding Township Municipal Properties

#### A. *General Policy Conditions*

1. Hunters must complete a Harding Township Hunters' Registration Application (see Appendix #1)
2. Hunters must hold a valid New Jersey hunting license.
3. Hunters must have a valid Harding Township Bow Hunting Permit. Copy has to be attached to request.
4. Bow hunting and driving for deer is the only form of hunting allowed.
5. Baiting is permitted.
6. Hunting shall generally be permitted throughout the deer bow hunting season.
7. Sunday bow hunting for deer is not legal on township owned property.
8. The township reserves the right to modify permitted dates and/or properties.
9. Hunters must provide a copy of their certificate of hunting liability insurance.
10. Tree Stand can be placed one week prior to start of season and **must be removed one week** after close of season. (All stands and structures must contain ownership information. (name, address, and phone number)) (Copy of Hunting Permit must be attached to tree stand)
11. Once approved hunters' will receive a permission letter (appendix #2), hunter's responsibilities (appendix #3), and a hunting map (appendix #4).
12. Drones are prohibited.

#### B. *Hunters' Responsibilities*

1. Capture Deer Management Unit (DMU) and Municipality as Harding Township when recording Automated Harvest Report System.
2. No hunting from positions within 300 feet of any building, dwelling, driveway or road.
3. No hunting within 50 feet of walking trails or recreational facilities.
4. Remove all personal property or waste from township property.
5. Immediately contact the Township of Harding regarding accidents, injuries, or damage to property.
6. Respect adjacent private property. If a hunter needs to follow a wounded animal onto private lands, permission must be obtained from the landowner.
7. Hunters shall be solely responsible for all risks associated with their presence and hunting activity on Harding Township property. The Township of Harding is not responsible for any personal injury or property damage resulting from such presence or activity, including hunting related accidents or injuries.
8. Drones are prohibited.

**C. *Activities Not Allowed***

1. Use of motorized vehicles on Harding Township properties.
2. Firearm hunting is not authorized.

**II. Harding Land Trust Properties**

**A. *Purpose***

1. The purpose of this Harding Land Trust Hunting Policy is to provide a framework for the conditions under which the Land Trust will make designated properties in which it has an ownership interest available to licensed hunters during deer hunting season. This policy provides clear guidance to hunters seeking to hunt on Land Trust property. The Land Trust's objective is to control the local deer herd as part of a complete wildlife management plan.
2. Use of Land Trust Property is a privilege extended to all legally-permitted hunters who abide by the rules and regulations of the State of New Jersey and the Harding Land Trust. Failure to do so may result in loss of hunting privilege and if warranted, referral to the NJ-DEP and/or Harding Police Department for possible enforcement action.

**B. *General Policy Conditions***

1. The following conditions will apply to all hunting on Land Trust property.
  - a. Bow hunting for deer is the only form of hunting allowed.
  - b. Hunters must hold a valid New Jersey hunting license, and have registered with Harding Township.
  - c. Hunters must have completed a Harding Land Trust Bow Hunting Permit Application and received written approval to engage in hunting activity on its property. (see appendix #5, form of application/approval)
2. Hunters must complete a Harding Township Hunters Registration Application. (see Appendix #1)
3. Hunters must hold a valid New Jersey hunting license.
4. Hunters must have a valid Harding Township Bow Hunting Permit. (Copy has to be attached to request)
5. Hunters must provide a copy of their certificate of hunting liability insurance.

**C. *Designated Hunting Properties***

1. The Land Trust reserves the right to designate additional or different properties at any time. Please contact the Harding Land Trust office for information on hunting locations.

D. *Permitted Hunting Days and Hours*

1. Hunting will be permitted on all designated Land Trust properties throughout the deer bow hunting season designated by the State of New Jersey. The Land Trust will post signs on designated properties indicating changes to the days and times when hunting is permitted. The Land Trust will also contact hunters by email informing of any changes to the days and times when hunting is permitted.
2. Primrose Farm will be open to all registered hunters from 10/19-20 to 11-28-20. Hunters will park at Barrett Field. The access road entrance will not be available.

E. *Hunters' Responsibilities*

1. Hunters are responsible for complying with all legal requirements. In addition, hunters must:
  - a. Promptly report each deer taken to NJ DEP and Harding Land Trust.
  - b. Not hunt from positions within 300 feet of any building, dwelling, driveway, or road.
  - c. Not leave any personal property or waste on Land Trust property.
  - d. Not hunt within 50 feet of walking trails or recreational facilities.
  - e. Not leave arrows behind, or report arrows not found to the Land Trust Office.
  - f. Immediately contact the Land Trust office regarding accidents, injuries, or damage to property.
2. Hunters must respect adjacent private property. If a hunter needs to follow a wounded animal onto private lands, permission must be obtained from the landowner.
3. Portable hunting stands and structures are permitted for the duration of the hunting season unless asked to be relocated or removed at the request of Harding Land Trust. Tree stands can be placed one week prior to the start of the season and must be removed one week after the close of the season. All stands and structures must contain ownership information: name, phone number, and copy of hunting permit must be attached to the tree stands.
4. The following activities are **not allowed**:
  - a. Cutting trees or vegetation or removing brush from properties
  - b. Motorized vehicles of any kind on Land Trust or Harding Township properties
  - c. Firearm Hunting
  - d. Use of Drones
5. Hunters are asked to help “keep an eye” on things when hunting and to inform the Land Trust if there are any activities taking place on the property of which we should be aware.

6. Hunters shall be solely responsible for all risks associated with their presence and hunting activity on Harding Land Trust property, and neither the Harding Land Trust nor its members or Trustees are responsible for any personal injury or property damage resulting from such presence or activity, including hunting related accidents or injuries.

F. ***Specific requirements for hunting at Harding Land Trust Primrose Farm:***

1. Hunters at Primrose Farm must meet the following qualifications:
  - a. Be a resident of Harding Township
  - b. Be an employee of Harding Township.
  - c. Be a volunteer for the New Vernon Fire Department.
  - d. Be a volunteer for the New Vernon Rescue Squad.
  - e. If an adequate number from the above group of hunters do not apply, Harding Land Trust may allow hunters from outside the Township to participate.
2. Permitted Hunting Days and Hours at Primrose Farm:
  - a. Hunting dates to be determined. Please contact the Harding Land Trust for more information.
  - b. Portable hunting stands and structures are permitted for usage only during the limited hunting period at Primrose Farm. All stands and structures must contain ownership information (name, address, and phone number). Stands must be removed at the end of the hunting period without exception. If a stand or other structure is left after the hunting period, it may be dismantled and removed by the Harding Land Trust staff.



**Appendix #1**

**HARDING TOWNSHIP HUNTER REGISTRATION\***

**TODAY'S DATE:** \_\_\_\_\_

**NAME:** \_\_\_\_\_

**ADDRESS:** \_\_\_\_\_

**E-MAIL ADDRESS:** \_\_\_\_\_

**PHONE NUMBERS:** \_\_\_\_\_

**CONSERVATION IDENTIFICATION NUMBER:** \_\_\_\_\_

Please attach copy of ID Card.

**DO YOU CARRY HUNTER LIABILITY INSURANCE? YES: NO:**

Please attach copy of *Declaration Page of Insurance*.

**I. VEHICLE(S) USED FOR HUNTING (Make, Model, Color and Plate Number):**

\_\_\_\_\_

**II. PRIVATE PROPERTY WHERE YOU HAVE PERMISSION TO HUNT & CELL PHONE # OF PROPERTY OWNER:** (Property owner's cell phone # must be with you at all times)

\_\_\_\_\_

**III. DO YOU CURRENTLY HUNT ON TOWNSHIP-OWNED PROPERTY? YES: NO:**

IF YES, WHERE: \_\_\_\_\_

**IV. DO YOU REQUEST NEW PERMISSION TO HUNT ON TOWNSHIP-OWNED PROPERTY?**

**YES: NO:**

IF YES, WHERE: \_\_\_\_\_

*By Submission of this application, I agree to indemnify both Harding Township and the Harding Land Trust for any claims which may result from my actions while hunting.*

**PLEASE RETURN THIS FORM TO:**        **Harding Township Municipal Clerk**  
**P.O. Box 666**  
**New Vernon, NJ 07976**

---

*For internal use only* – Date Received: \_\_\_\_\_

**\* Required for hunting on Harding Township property**

**Form Date: August 2020**

21 BLUE MILL ROAD, POST OFFICE BOX 666  
NEW VERNON, NEW JERSEY 07976  
TELEPHONE (973) 267-8000  
MARIAN & ALLAN P. KIRBY MUNICIPAL BUILDING





## **Appendix #2 – Permission Letter**

Date

Participant Address

Dear

You have permission to hunt for deer only on the listed Township-owned property under the associated conditions. This permission is for the 2020-2021 hunting season and must be renewed (if wanted) for subsequent seasons. Included is a Parking Permit which should be displayed in your vehicle when exercising this permission.

<b><u>Block / Lot</u></b>	<b><u>Property Name/Hunting Conditions</u></b>
Block 46 Lot 4.01	105 Bailey's Mill and Young's Road (driving only) Latitude 40.738865, Longitude (-)74.527454
Block 35.01 Lot 18	Rte. 202/287 (880 Mt. Kemble Ave) & Glen Alpin Road (bow hunting) Latitude 40.75198, Longitude (-)74.527613
Block 8 Lot 9.01	Margetts Field-1 Featherbed Lane (bow hunting) Latitude 40.74937, Longitude (-)74.477285
Block 2 Lot 18	Waterman property Loantaka Lane North – 634 Spring Valley Road (bow hunting) Latitude 40.759504, Longitude (-)74.451498
Block 23 Lot 1	Gatehouse property--James Street & 110 Harter Road (bow hunting) Latitude 40.763665, Longitude (-)74.487924
Block 27 Lot 3.01	Eggert Property--663 Mt. Kemble Avenue (bow hunting) Latitude 40.757956, Longitude (-)74.523776
Block 35, Lot 14	Rossell Property – 140 Bailey's Mill Road (bow hunting) Latitude 40.742852, Longitude (-)74.529278
Block 48, Lot 2	96 Young's Road Latitude 40.73744, Longitude (-)74.52553

If you desire to hunt on Township Property not listed above, you can make your request known to the Municipal Clerk, who will make the recommendation to the Township Committee.

Also attached, is the list of hunters who have received permission to hunt on Township-owned land. We suggest that you coordinate access to the properties amongst yourselves, to prevent conflicts and accidents. This list is accurate as of the date of this letter.

Sincerely,

21 BLUE MILL ROAD, POST OFFICE BOX 666  
NEW VERNON, NEW JERSEY 07976  
TELEPHONE (973) 267-8000

MARIAN & ALLAN P. KIRBY MUNICIPAL BUILDING





## Appendix #3

### **Township of Harding Hunting Responsibilities 2020-2021**

#### **Hunters Responsibilities:**

1. Hunters are responsible for complying with all legal requirements.
2. In addition, hunters are expected to adhere to common hunting best practices.
3. Capture Deer Management Unit (DMU) and Municipality as Harding Township, when recording Automated Harvest Report System.
4. No hunting from positions within 300 feet of any building, dwelling, driveway or road.
5. No hunting within 50 feet of walking trails or recreational facilities.
6. Remove all personal property or waste from township property.
7. Immediately contact the Township of Harding Police Department regarding accidents, injuries, or damage to property.
8. Respect adjacent private property. If a hunter needs to follow a wounded animal onto private lands, permission must be obtained from the landowner.
9. Hunters shall be solely responsible for all risks associated with their presence and hunting activity on Harding Township property. The Township of Harding is not responsible for any personal injury or property damage resulting from such presence or activity, including hunting related accidents or injuries.
10. Hunters must complete a Harding Township Hunters' Registration Application. (see Appendix #1)
11. Hunters must hold a valid New Jersey hunting license.
12. Hunters must have a valid Harding Township Bow Hunting Permit. Copy has to be attached to request.
13. Tree stand can be placed one week prior to start of season and **must be removed one week** after close of season on Harding Township Municipal properties. Copy of Hunting Permit must be attached to tree stand.
14. Hunters must provide a copy of their certificate of hunting liability insurance.
15. Portable hunting stands and structures are permitted on Harding Land Trust properties for day use only and must be removed daily. All stands and structures must contain ownership information. (name, address, and phone number) If a stand or other structure is left overnight, it may be dismantled and removed by Land Trust staff.

16. Baiting is permitted on Harding Township Municipal Properties and Harding Land Trust Properties.
17. Drones are prohibited.

The following activities are not allowed:

1. Use of motorized vehicle on Harding Township or Harding Land Trust properties.
2. Firearm hunting is not authorized.

21 BLUE MILL ROAD, POST OFFICE BOX 666  
NEW VERNON, NEW JERSEY 07976  
TELEPHONE: (973) 267-8000  
MARIAN & ALLAN P. KIRBY MUNICIPAL BUILDING

## Appendix #4

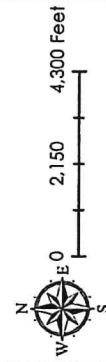
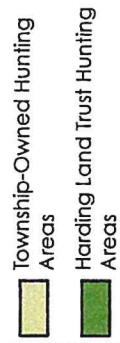

**HGA**  
HEYER, GRUEL & ASSOCIATES  
August 2018





Harding Land Trust  
PO BOX 576  
Harding, NJ 07976  
(973) 267-2515

**Appendix 5**

## **Harding Land Trust Hunting Permit Application**

**THIS DOCUMENT, IF APPROVED IN WRITING BY HARDING LAND TRUST AS INDICATED BELOW, PROVIDES THE UNDERSIGNED PERMISSION TO ENTER IDENTIFIED HARDING TRUST PROPERTY LOCATIONS FOR THE LIMITED PURPOSE OF BOW HUNTING FOR DEER DURING THE FALL DEER HUNTING SEASON, ON THE TERMS AND CONDITIONS PROVIDED HEREIN.**

**NAME:** \_\_\_\_\_

**ADDRESS:** \_\_\_\_\_

**EMAIL ADDRESS:** \_\_\_\_\_

**PHONE NUMBERS:** \_\_\_\_\_

**CONSERVATION IDENTIFICATION NUMBER:** \_\_\_\_\_  
Please attach a copy of ID Card and Deer Permit.

**HUNTER LIABILITY INSURANCE POLICY:** \_\_\_\_\_  
Please attach a copy of Policy, Declaration Page, or Certificate of Insurance.

**HAVE YOU FAMILIARIZED YOURSELF WITH THE PROPERTY ON WHICH YOU ARE SEEKING TO HUNT, INCLUDING BOUNDARIES, ADJACENT PROPERTIES, TRAILS AND HABITAT SENSITIVITIES (see Attachment 2, Designated Properties):** YES OR NO

**HAVE YOU READ THE HARDING LAND TRUST HUNTING POLICY?** YES OR NO



Harding Land Trust  
PO BOX 576  
Harding, NJ 07976  
(973) 267-2515

**Appendix #5 Cont'd**

**By signing this application and in consideration of the rights provided hereunder, you:**

1. Acknowledge that Harding Land Trust makes no representations regarding the condition or safety of its properties for purposes of hunting,
2. agree to comply with the Harding Land Trust Hunting Policy, posted signs on Harding Land Trust Property, as well as Local, State and Federal regulations,
3. agree that you assume all risks associated with your presence and hunting activity on Harding Land Trust property, and that neither the Harding land Trust nor its members or Trustees is responsible for any personal injury or property damage resulting from your presence or activity, including hunting related accidents or injuries, and
4. agree that you will defend, indemnify and release the Harding Land Trust, its members and trustees, from any and all claims, liabilities, damages or costs of whatever nature that may arise or be made in connection with your presence or activity on Harding Land Trust property.

**Please sign your name** \_\_\_\_\_

**PLEASE RETURN THIS FORM AND YOUR COPY OF YOUR DECLARATION PAGE OR CERTIFICATE OF INSURANCE NAMING HARDING LAND TRUST AS AN ADDITIONAL INSURED TO:**

**Harding Land Trust**  
PO Box 576  
110 Harter Road  
New Vernon, NJ 07976  
Phone: 973-267-2515

Harding Land Trust office hours are by appointment only. Please call 973/267-2515 to schedule.

**FOR INTERNAL USE ONLY** – Date Received \_\_\_\_\_

**Approved:**

\_\_\_\_\_  
**Harding Land Trust**